

## Specification sheet LX 1159

### Siphonic Parapet drainage systems Series 62 DRAINJET® without roof penetration

Emergency drainage	
Siphonic flow	
Silent Power	
<b>Discharge rate:</b>	<b>36,0 l/sec</b>
<b>Water height:</b>	<b>75 mm</b>
<b>Roof penetration:</b>	<b>0 mm</b>
<b>Diameter:</b>	<b>DN 100</b>
<b>LX-Number:</b>	<b>LX 1159</b>
<b>Weir height:</b>	<b>60 mm</b>
<b>Drain:</b>	<b>not ventilated</b>
<b>Downpipe:</b>	<b>not ventilated</b>
<b>Downpipe height:</b>	<b>min 4,2 m</b>
<b>Drainage:</b>	<b>on floor</b>

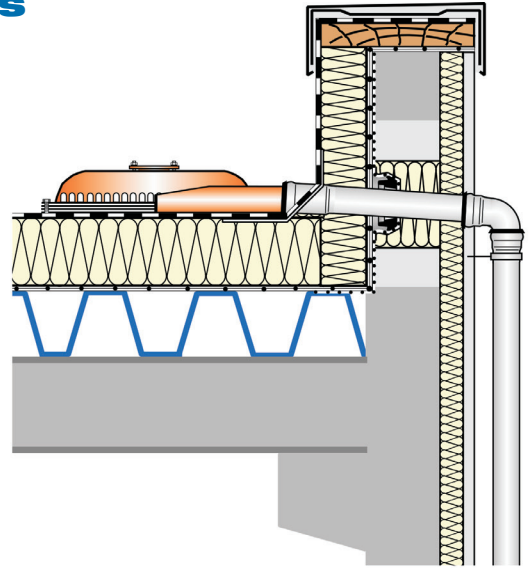

#### LX 1159 Piece list

- 1 x Art.-No. 01349.100X, POWER DRAINJET® Parapet drain
- 1 x Art.-No. 01401.100X, LORO-X Pipe with one socket
- 1 x Art.-No. 13235.100X, LORO-Sliding flange
- 1 x Art.-No. 00300.100X, LORO-X Bend
- 1 x Art.-No. 01011.100X, LORO-X Pipe with one socket
- 1 x Art.-No. 00320.100X, LORO-X Bend

- 4 x Art.-No. 00911.100X, LORO-X Sealing elements
- 2 x Art.-No. 00975.100X, LORO-X Pipe clamps
- 1 x Art.-No. 00986.000X, LORO-X Lubricant
- 3 x Art.-No. 00806.100X, LORO-X Anchor clips
- 2 x Art.-No. 09604.200X, LORO-X Thread rods

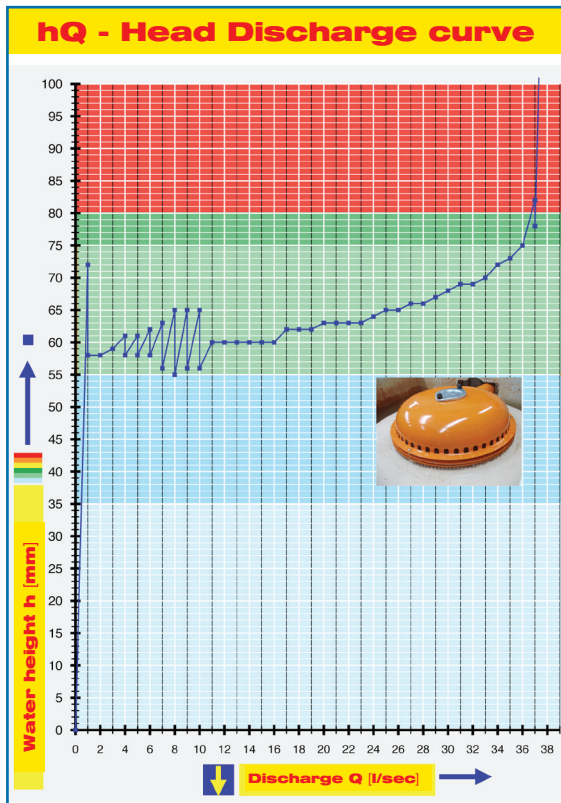

**Systempower**

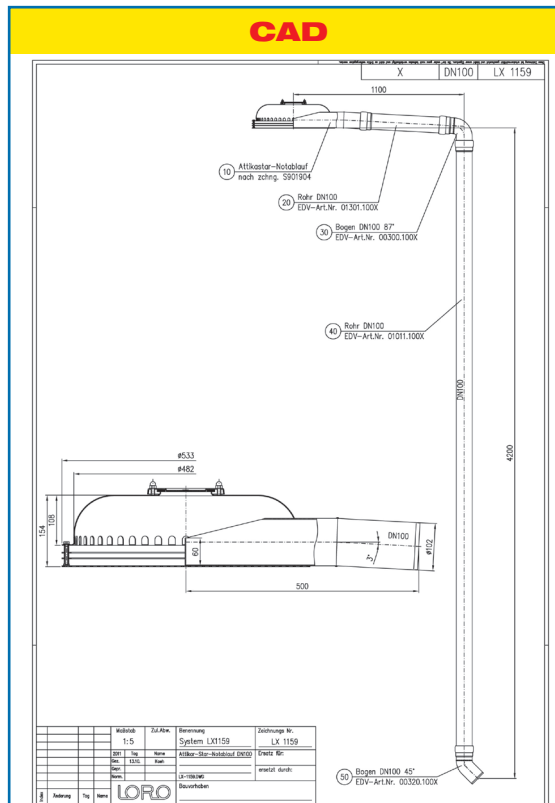

**Systemshape**

<b>Water height</b>	mm	35	40	45	50	55	60	65	70	<b>75</b>	80	85	90	95	100	105
<b>Discharge</b>	l/sec							26,0	33,0	<b>36,0</b>	36,5	37				
											<b>Power</b>					

# LORO-X POWER DRAINJET® siphonic parapet drainage systems

## LORO-X POWER DRAINJET® parapet emergency drain, DN 100

with **bonding flange 45°** for **bituminous roofing sheets**

Drain Art.-No. 01349.100X

Weight: 21,1 kg

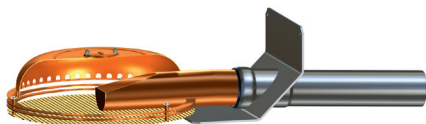

**LX1159-3X**

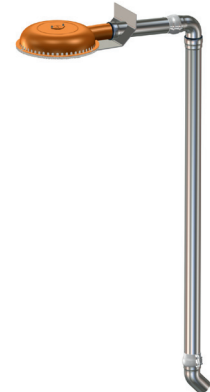
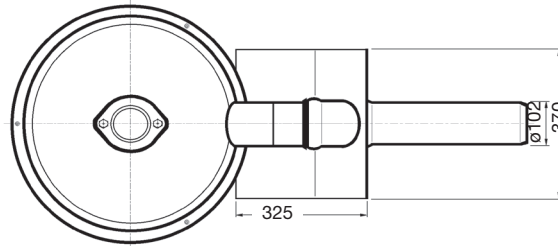
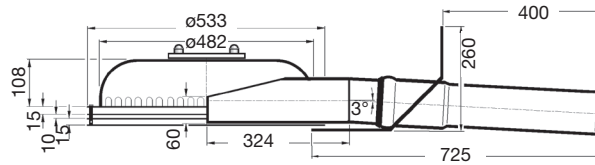

## LORO-X Pipe with one socket

made of hot-dip galvanised steel, DN 100  
 250 mm long Art.-Nr. 01401.100X  
 2000 mm long Art.-Nr. 01101.100X  
 4000 mm long Art.-Nr. 01011.100X



## LORO-X Bend 87°

made of hot-dip galvanised steel, DN 100  
 Art.-No. 00300.100X



## LORO-X Bend 45°

made of hot-dip galvanised steel, DN 100  
 Art.-No. 00320.100X



## LORO-X Sliding flange

for attaching the vapor barrier, with pre-installed connection sleeve including fastening screws  
 Art.-No. 13235.100X



## LORO-X Sealing elements

Art.-No 00911.100X



## LORO-X Anchor clip

made of hot-dip galvanised steel, DN 100  
 Art.-Nr. 00806.100X



**LORO-X Pipe clamps**  
 Art.-No. 00975.100X  
**LORO-X Threaded rods**  
 Art.-No. 09604.200X

### Please note:

For drainage systems with siphonic flow it is vital that only LORO-X pipes and fittings in the combination as indicated are used. Mixture or exchange of system parts may result in lower discharge capacities! The height of the downpipe must be a min. 4.2m for the indicated capacity to be obtained. If roof drain and downpipe are fitted by different crews, then do follow the system setup acc. to the LX-data sheet at [www.loro-x.com](http://www.loro-x.com)

**Heat tracing:** Lorowerk recommends to check all drains and pipes with regard to their frost-sensibility. Where necessary, these parts should be upgraded with heat tracing.